

CHAMPIONS SQUARE

club XLIV & ENCORE | OPENING ACT

SPECIAL EVENT GUIDE



Champions Square | P.O. Box 52439 | New Orleans, LA 70152
504.587.3663 | www.champions-square.com



VENUE INFORMATION

CHAMPIONS SQUARE

TOTAL SPACE

- Square: 45,435 sq. ft.
- Square with LaSalle St.: 89,870 sq. ft.

CAPACITIES

- Venue capacity is determined on the overall event setup and any ancillary spaces utilized

BACK OF HOUSE

- 1 large dressing room equipped with private restroom
- 6 small dressing rooms
- 1 private restroom with shower
- 1 shared restroom with shower

RESTROOMS

- Total Men's Facilities: 20
- Total Women's Facilities: 18
- Additional restrooms in ancillary spaces

FOOD & BEVERAGE / MERCHANDISE

- SMG retains the sole right to sell all food, beverage and merchandise in the Square

PUBLIC PARKING

- On site parking available

WEATHER

- Events are rain or shine
- SMG has authority to delay, suspend or cancel an event due to dangerous conditions

STAFFING

- All in-house SMG personnel as deemed necessary

EQUIPMENT

- Staging, 2 entrance trusses, 2 box trusses, barricades, chairs, and tables. Equipment is available based on inventory

EXCLUSIVES

- Medical Services and SMG Event Staff
- Certain product, messaging, sponsor signage and pouring rights apply
- SMG event staff is the exclusive operator of all existing audio and video equipment
- Centerplate is the exclusive beverage provider
- SMG facilities are Ticketmaster venues



VENUE INFORMATION

CHAMPIONS SQUARE



SUPERDOME EXTERIOR LIGHTING

- CLIENT may request specialty exterior lighting color on the Mercedes-Benz Superdome for an event
- Lighting requests cannot be confirmed until (30) days prior to event
- PMS color request and lighting mode must be submitted in writing (10) days prior to event date
- Lighting request will be given priority based on the space utilized within the complex

EXTERIOR LIGHTING RESTRICTIONS

- Lighting is not offered during daylight hours
- Light requests are for event day(s) only
- SMG reserves the right to project the Mercedes-Benz logo on the exterior of the facility during any given event
- Color variations from the provided PMS color may occur
- If hosting an event 24 hours prior to a New Orleans Saints or New Orleans Pelicans Game Day, lighting requests with opposing team colors will not be granted.

EVENT LIGHTING PRIORITY

- Lighting requests will be given priority based on the space usage within the complex
 - **1st Priority** – SMG Management – special circumstances/ National Holidays etc. as deemed necessary
 - **2nd Priority** – New Orleans Saints and New Orleans Pelicans on Game Days and other select dates chosen by teams
 - **3rd Priority** – Event hosted on the Mercedes-Benz Superdome Main Arena Floor
 - **4th Priority** – Event hosted in Champions Square
 - **5th Priority** – Event hosted in Mercedes-Benz Superdome 200 Level Club Lounge(s)
 - **6th Priority** – Event hosted on Mercedes-Benz Superdome Grand Staircase
 - **7th Priority** – Other requests subject to event schedule and SMG's discretion

PRODUCTIONS & SPECS

CHAMPIONS SQUARE

SOUND LIMIT

- 105 C-Weighted DB at FOH

STAGE POWER

- Up stage left:
 - 200 Amp; 3 Phase
 - 200 Amp; 3 Phase
 - 200 Amp; 3 Phase
- Up stage right:
 - 200 Amp; 3 Phase
 - 200 Amp; 3 Phase
 - 400 Amp; 3 Phase

STAGE/ROOF

Stage:

60 ft. wide x 48 ft. deep x 6 ft. high

Wings:

16 ft. wide x 27 ft. deep wings on stage left and stage right

Stage to Steel:

32 ft. on the corners of main grid, 35 ft. at the center of main grid, 31 ft. in audio bays, includes rear & side walls

Roof:

65 ft. wide x 48 ft. deep main grid with 19 ft. wide x 17 ft. deep audio bays

Rigging capacity:

48,000 lbs. from main grid and 10,000 lbs. from each audio bay, totaling 68,000 lbs.

** Staging Roof is not equipped with sound or lighting system*

PREFERRED RIGGING CREW

- Rhino Louisiana, LLC
Ray Cullen: 255-644-5600
ray@rhinostaging.com

A/V, TECHNOLOGY & PRODUCTION

- 32 ft. wide x 18 ft. high, 10 mm LED video screen
- On-site video control room with 16 input HD/SD switcher
- 2 Ikegami HL45 cameras & 1 Vinten tripod
- Wireless microphones and communications systems
- Background audio system with 24 full range speakers and 10 subwoofers in Champions Square and 18 speakers located along LaSalle St. and the Mercedes-Benz Superdome Grand Staircase
- Mix position: Distance from downstage edge 105' - 120' size: 20' x 20'
- Panasonic SDI switcher
- Yamaha audio mixer
- Limited audio & P.A. systems are available; if CLIENT chooses to provide CD or MP3 player it will be played at the discretion of SMG
- Audio reinforcement will be required for live entertainment

CHAMPIONS SQUARE LED BOARD/club XLIV TELEVISION GRAPHICS

- CLIENT is responsible for all production personnel labor fees to upload content and/or test prior to the event.
- CLIENT is responsible for all production personnel labor fees to operate board and televisions/run content during event hours.
- Final content is due to the assigned SMG Event Coordinator at least five (5) business days prior to program. No exceptions.
- The assigned SMG Event Coordinator will include any applicable fees related to use of the board and televisions in cost estimate submitted to CLIENT.

LIGHTING

- 40 LED general area wash fixtures throughout Champions Square
- No stage lights provided - Client must provide all stage lighting (may be rigged from stage roof; equipment weight restrictions will apply)

LOAD IN / LOAD OUT AREA

- 2 trucks at dock in tunnel - upstage 50' push
- Multiple trucks ground load downstage
- Upon unloading trucks must clear the loading zone
- Truck parking in Lot 3 (if available) or other designated location
- Roll door at rear of stage is 10 ft. high and 8 ft. wide

IT INFORMATION

- Champions Square is fully WiFi & cellular equipped. Any additional telecom or data services can be requested from AT&T, toll-free at 1-866-620-6000



STAGE, SOUND & LIGHTING

- Due to curfew regulations, all music and entertainment in Champions Square must cease by 10:30 PM Sunday - Thursday and 11:00 PM Friday - Saturday.
- No amplified sound of any kind may commence prior to 8:00 AM on any day of the week. This includes, but is not limited to, sound checks, rehearsals, performances and PA announcements. The sound level measured from the mix location must be no higher than 70 decibels between the hours of 8:00 AM and 10:00 AM, and no higher than 105 decibels after 10:00 AM until the applicable curfew time listed above.
- CLIENT will be responsible for all expenses related to electrical power hookups, and any rigging fees associated with the use of the stage in Champions Square.
- No stage lighting provided on Champions Square stage. CLIENT is responsible for renting all stage lighting.
- Existing audio provided in Champions Square is for background music only and is not equipped for band sound. CLIENT is responsible for renting any additional A/V required.
- Outside Entertainment (i.e. DJs/Bands) will not be allowed to tie into Champions Square sound system. Any outside entertainment brought in must provide a "Turnkey" solution including AMP, SPEAKS, MIX, MIC, Audio Source, cabling etc.
- CLIENT will be responsible for fees associated with raising and/or lowering the stage roof for rigging additional sound/lighting equipment and/or potential hazardous weather.

POLICIES & PROCEDURES

CHAMPIONS SQUARE

CURFEW:

- 10:30pm Sunday - Thursday
- 11:00pm Friday & Saturday

VENUE CAPACITY:

- SMG will follow event capacity based on CLIENT's final configuration and in accordance with fire code and patron safety.

LASALLE STREET ACCESS:

- LaSalle Street must remain open as a pedestrian walkway to the general public during CLIENT move-in and move-out whenever possible. SMG will not allow pedestrian traffic when deemed necessary during move-in and move-out for safety reasons.
- CLIENT understands that twenty (20) feet of space paver to paver on LaSalle Street (from Dave Dixon to Poydras) must be left clear for emergency vehicles and truck deliveries to Benson Tower. It is required that tenants of Benson Tower be given reasonable access to their offices at all times.
- CLIENT understands the Benson Tower Loading Dock must remain accessible to Benson Tower tenants at all times. Event elements are not permitted to be placed near the Benson Tower Loading Dock. Please speak with your SMG Event Coordinator for specifics.

EVENT SCHEDULE:

- There is the possibility that event(s) will be scheduled at the Mercedes-Benz Superdome and/or Smoothie King Center during CLIENT move-in days, program days and/or move-out days.
- CLIENT understands that SMG will make available for use by others, such portions, areas and facilities within the SMG Complex.
- CLIENT is aware that LaSalle Street may be utilized as an access area for another contracted complex event during CLIENT'S move-in/move-out time. The assigned SMG Event Coordinator will work with CLIENT on the logistics to ensure patron safety.
- SMG will not be responsible for any overtime outside contractor (i.e. decorator) charges due to any delays.
- CLIENT agrees to cooperate in good faith with SMG and with those persons using other portions and areas of the SMG Complex, especially during periods of ingress and egress, in order to make mutual use of the SMG Complex harmonious and agreeable.

MANAGER'S UNMANNED AIRCRAFT SYSTEM (UAS) POLICY:

- The possession, operation, or use of an unmanned aircraft system (UAS) or drone is prohibited on Mercedes-Benz Superdome, Smoothie King Center, or Champions Square property without prior, written permission from management. Furthermore, persons operating a UAS on Mercedes-Benz Superdome, Smoothie King Center, or Champions Square property may be subject to criminal or civil penalties by the Federal Aviation Administration (FAA).

MISCELLANEOUS:

- No paper confetti is allowed. Large mylar streamers are acceptable.
- No temporary signage may be affixed to the exterior of Benson Tower or Opening Act.



CATERING INFORMATION

CHAMPIONS SQUARE



OUTSIDE CATERING POLICIES BASED ON EVENT TYPE:

- SMG's in-house beverage provider, Centerplate, retains the sole right to provide any and all beverage service with the exception of coffee and tea.
- No kitchens are available for use by Outside Caterer on Champions Square or ancillary venue premises.
- Your assigned SMG Event Coordinator will assist in identifying a prep area/cooking location. Prep area/cooking space is based upon availability and location will be determined by the needs of the event and as approved by SMG.
- Outside Caterer is responsible for bussing/cleanup.
- Outside Caterer is responsible for providing and setting up all catering prep tables, buffet tables & associated linens, dining tables & associated linens and dining chairs.
- For receptions, Centerplate will provide lucite-ware and bar staff. Any request for glassware becomes the responsibility of the Outside Caterer.
- For all seated dinners, Centerplate opens all alcoholic bottles; Outside Caterer pours.
- Outside Caterer responsible for providing all china, silverware and glassware for seated dinners.

OUTSIDE CATERING INSURANCE REQUIREMENTS AND DAMAGE DEPOSIT:

- Outside caterer, including Food Trucks, must be a licensed caterer with a proven record of successful, quality events. All outside caterers must carry a minimum of \$2,000,000 (two million dollars) of insurance and indemnification and must submit insurance certificate to SMG. In addition, Food Trucks must show proof of product liability insurance.

SMG CATERING RELATED EQUIPMENT:

- All SMG equipment is based on available in-house inventory on event date.
- NOTE: Labor fees for the setup and removal of all in-house furnishings (tables, chairs, staging, risers, dance floor etc.) will apply.
- If CLIENT is utilizing SMG's in-house caterer, Centerplate, there will be no associated rental fees for the use of in-house tables and chairs.
- If CLIENT is utilizing an outside caterer, rental fees will apply for the use of in-house tables and chairs. Please speak to the assigned SMG Event Coordinator for rental fees.
- NOTE: Table linens are NOT provided by MANAGER with the rental of equipment.
- Staging (4x8ft), Risers (4x8ft and 3x8ft), Oak colored dance floor (floor size varies depending on final location of the dance floor) will be provided at no additional rental charge.
- NOTE: SMG equipment utilized cannot be left overnight in Champions Square. If Event schedule dictates overnight/rush set up or breakdown, CLIENT is responsible for all associated labor fees.

CONFIGURATION

CHAMPIONS SQUARE

JANUARY THROUGH EARLY SPRING

- During the time frame listed above, the Square will be offered to CLIENT with ancillary elements in place (as shown in below configuration). Ancillary Elements include: Streetcar Food Truck.
- CLIENT may bring in tents from an outside source or rent tents from SMG. If tents are provided by SMG, CLIENT will be responsible for tent rental, installation and removal fees. The assigned SMG Event Coordinator will provide CLIENT with the applicable labor fees.
- Installation and removal of any tents is based upon time permitted and feasibility based upon the Champions Square event schedule. Speak with your assigned SMG Event Coordinator (overnight and/or rush fees may apply).
- Based upon event schedule and feasibility, if CLIENT wishes to remove or relocate the Streetcar Food Truck, applicable labor fees will be charged for removal and reinstallation.

TENTING OVERVIEW:

- The city of New Orleans requires a tent permit for each tent/all tent sizes.
- Tent applications can be found at <https://nola.gov/onestop/events/tents-stages/canopy-tent-temporary-membrane-structure-permit/>
- Please contact your assigned SMG Event Coordinator for additional information regarding tenting policies and procedures.
- Anchoring: Only concrete or water barrels may be used for anchoring tents in Champions Square. Stakes are strictly prohibited.

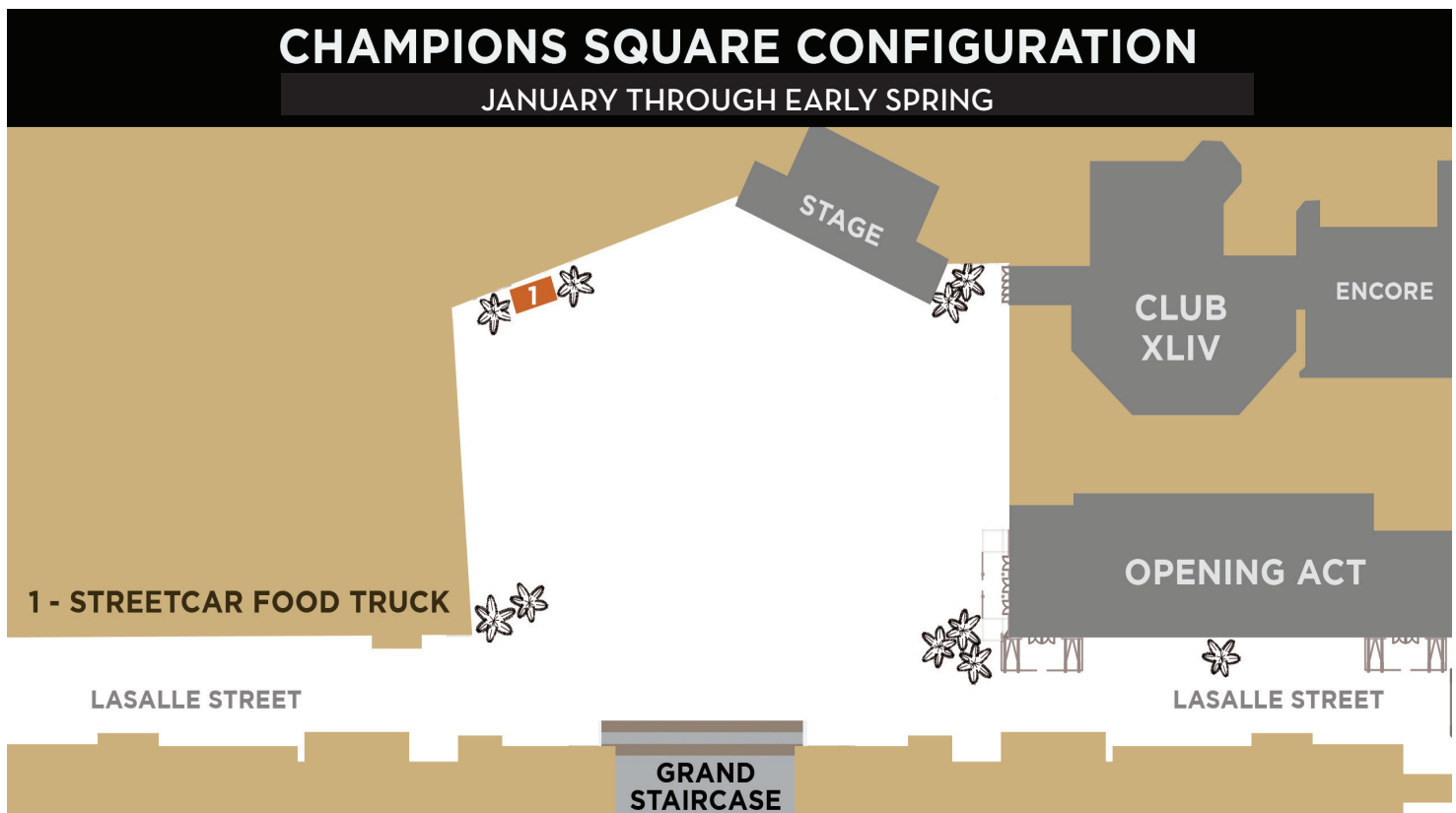

Configuration subject to change based upon Champions Square final event schedule. Please speak to your assigned SMG Event Coordinator.

CONFIGURATION

CHAMPIONS SQUARE

EARLY SPRING THROUGH LATE SUMMER

- During the time frame listed above, the Square will be offered to CLIENT with tents and ancillary elements in place (as shown in below configuration). Ancillary Elements include: Seating risers, Streetcar Food Truck and Beer Garden.
- CLIENT may request for Seating Risers and Beer Garden to be removed with no fees incurred.
- A rental fee will apply for any SMG tents utilized by CLIENT. Rental fees will NOT apply for any SMG tents utilized by Centerplate for food and/or beverage service for CLIENT'S Event.
- If CLIENT does NOT utilize tents, SMG will put front cover on tents at no charge to CLIENT.
- If CLIENT wishes to remove or relocate any tents, applicable labor fees will be charged for removal/relocation and reinstallation. The assigned SMG Event Coordinator will provide CLIENT with the applicable labor fees.
- Removal of tents is based upon time permitted and feasibility based upon the Champions Square event schedule. Speak with your assigned SMG Event Coordinator (overnight and/or rush fees may apply).
- Based upon event schedule and feasibility, if CLIENT wishes to remove or relocate the Streetcar Food Truck, applicable labor fees will be charged for removal and reinstallation.

TENTING OVERVIEW:

- The city of New Orleans requires a tent permit for each tent/all tent sizes.
- Tent applications can be found at <https://nola.gov/onestop/events/tents-stages/canopy-tent-temporary-membrane-structure-permit/>
- Please contact your assigned SMG Event Coordinator for additional information regarding tenting policies and procedures.
- Anchoring: Only concrete or water barrels may be used for anchoring tents in Champions Square. Stakes are strictly prohibited.

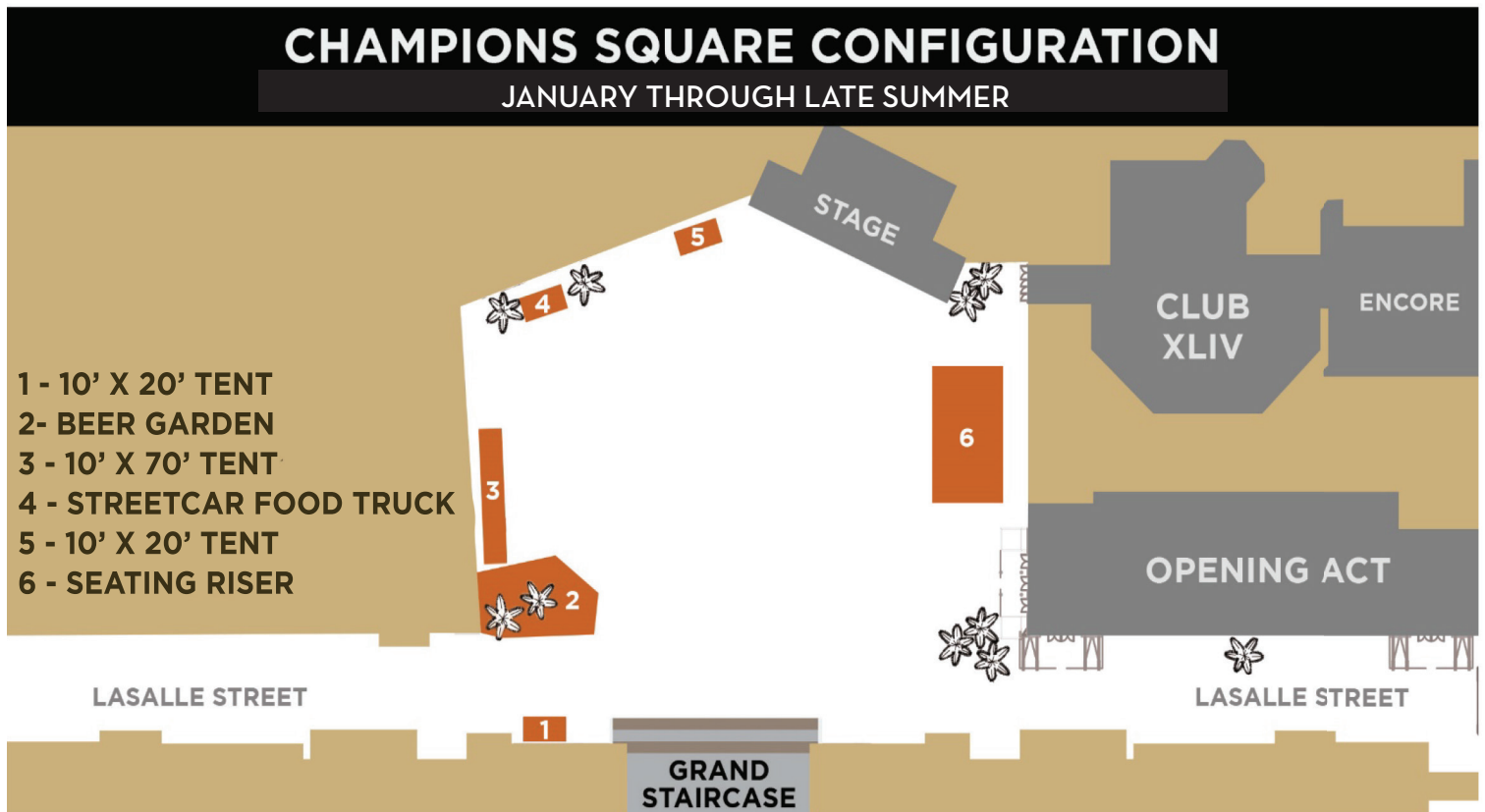

Configuration subject to change based upon Champions Square final event schedule. Please speak to your assigned SMG Event Coordinator.

CONFIGURATION

CHAMPIONS SQUARE

LATE SUMMER THROUGH JANUARY

- During the time frame listed above, the Square will be offered to CLIENT with tents and ancillary elements in place (as shown in below configuration). Ancillary Elements include: Streetcar Food Truck and Beer Garden.
- CLIENT may request for Beer Garden to be removed with no fees incurred.
- A rental fee will apply for any SMG tents utilized by CLIENT. Rental fees will NOT apply for any SMG tents utilized by Centerplate for food and/or beverage service for CLIENT'S Event.
- If CLIENT does NOT utilize tents, SMG will put front cover on tents at no charge to CLIENT.
- If CLIENT wishes to remove or relocate any tents, applicable labor fees will be charged for removal/relocation and reinstallation. The assigned SMG Event Coordinator will provide CLIENT with the applicable labor fees.
- Removal of tents is based upon time permitted and feasibility based upon the Champions Square event schedule. Speak with your assigned SMG Event Coordinator (overnight and/or rush fees may apply).
- Based upon event schedule and feasibility, if CLIENT wishes to remove or relocate the Streetcar Food Truck, applicable labor fees will be charged for removal and reinstallation.

TENTING OVERVIEW:

- The city of New Orleans requires a tent permit for each tent/all tent sizes.
- Tent applications can be found at <https://nola.gov/onestop/events/tents-stages/canopy-tent-temporary-membrane-structure-permit/>
- Please contact your assigned SMG Event Coordinator for additional information regarding tenting policies and procedures.
- Anchoring: Only concrete or water barrels may be used for anchoring tents in Champions Square. Stakes are strictly prohibited.

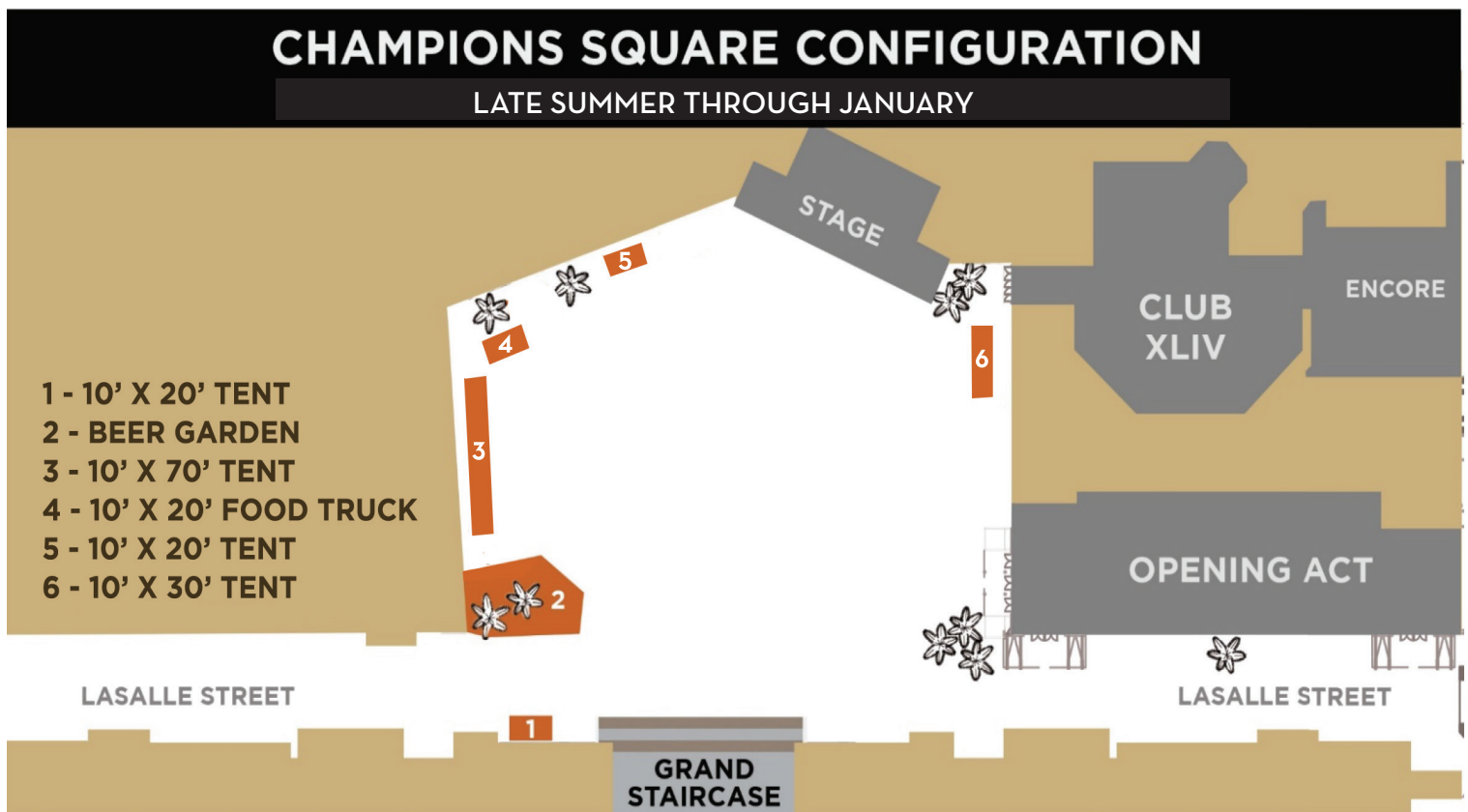

Configuration subject to change based upon Champions Square final event schedule. Please speak to your assigned SMG Event Coordinator.

SEATING RISER 60' X 24'



SEATING RISER 60' X 24'



STREET CAR FOOD TRUCK



STREET CAR FOOD TRUCK



STREET CAR FOOD TRUCK RENTAL INFORMATION

RENTAL COST

- Rental = \$2,000 per day.

EQUIPMENT:

- Single Door Reach-In Refrigerator
- Single Door Reach-In Freezer
- Refrigerated Prep Station
- (2) Gas Convection Oven
- (3) Gas Deep Fat Fryer
- 4 Burner Gas Char-grill
- Neico Chargrill Hamburger Impinger
- (3) 4' Prep tables (with under counter storage)
- 3 compartment hot/cold pan sink
- Handwashing sink

All Cooking Equipment is gas powered. A hands-on tutorial of equipment functionality will be given prior to the rental date. The unit is supplied with a continuous water source that is fed through an on demand heating system, supplying constant hot water.

The Street Car Food Trailer has 3 service windows with bug screens and service lighting and service counters.

A refundable damage/cleaning deposit of \$1000 will be assessed for the use of the trailer.

CONTACT:

Kernell Jupiter, General Manager, Centerplate
P 504.558.6280 / E kernell.jupiter@centerplate.com

BEER GARDEN



OPENING ACT



OPENING ACT

CAN ONLY BE RENTED IN CONJUNCTION WITH CHAMPIONS SQUARE

SPACE/CAPACITIES

- Total Square Footage: 12,000
- Capacity: 800 Reception
- Existing Lounge Seating for 120

FURNISHINGS & FIXTURES

- One extra-long fixed bar
- 4 fixed food service areas with 8 service points
- 4 black leather couches and 41 black leather chairs
- 12 ottomans
- 12 rectangular community style high boys with 48 barstools
- 6 aluminum high boys with 36 barstools
- 12 high boys with 36 leather barstools
- 6 mesh tables with 24 barstools
- 29 starburst light fixtures throughout the space
- Custom New Orleans-inspired artwork throughout the space

AUDIO & VIDEO

- (7) 60-inch flat screen televisions
- (24) 42-inch flat screen televisions with the ability to display live video feed from Champions Square, image slideshows and video presentations

- 16-channel mixing console with the ability to include microphones, iPod or other MP3 player
- Wireless microphones and communications systems
- Full range audio system with speakers recessed in the ceiling throughout the space

CATERING & CONCESSIONS

- SMG's in-house caterer, Centerplate, retains the sole right to provide all beverage service
- Client may utilize Centerplate for food service or Client may opt to bring in an outside caterer of their choice. A per-person catering buyout fee/minimum will apply
- Centerplate is the exclusive cash sales concessionaire

RESTROOMS

- Mens restrooms: 4 facilities
- Womens restrooms: 4 facilities

SPONSORS

- Sponsorship rights vary based upon event type

PARKING / BUS DROP-OFF

- Convenient and accessible parking in close proximity offered at competitive rates
- On-site lots for parking/staging of oversized vehicles (based on availability)
- Buses may access LaSalle St. and drop guests off directly in Champions Square

EXCLUSIVES

- Medical Services and SMG Event Staff
- Certain product, messaging, sponsor signage and pouring rights apply
- SMG event staff is the exclusive operator of all existing audio and video equipment
- Centerplate is the exclusive beverage provider

STAFFING

- All in-house SMG personnel as deemed necessary



CLUB XLIV & ENCORE



SPACE / CAPACITIES

- club XLIV: 9,500 sq. ft.
 - 550 reception / 200 seated
- Encore: 8,400 sq. ft.
 - 450 reception / 300 seated
- Total: 17,900 sq. ft.
 - 1,000 reception / 500 seated

CLUB XLIV FURNISHINGS & FIXTURES

- 2 fixed bars
- 9 black and ivory leather sofas
- 9 highboys with 27 black leather barstools
- (23) 42-inch tables with 92 black leather chairs
- Custom New Orleans-inspired artwork throughout the space
- Specialty audio, video and lighting packages

CLUB XLIV LIGHTING

- LED color up-lights around the perimeter of the room
- Customizable gobo locations: 2 floor projections (one at each entrance)
Associated fees apply for creation of custom gobos
- 8 dimmable chandeliers
- 3 rows of 5 dimmable, modern crystal chandeliers
- Illuminated bar

STAFFING

- All in-house SMG personnel as deemed necessary

CLUB XLIV AUDIO

- Full range audio system with speakers recessed in the ceiling throughout the space
- 16-channel mixing console with the ability to include microphones, iPod or other MP3 player
- Sound for LED televisions can be played throughout the in-house sound system

CLUB XLIV VIDEO

- Nine 42 in. LED televisions located throughout the club with HDTV capabilities and Cox Cable TV channels (capable of displaying logos, videos, presentations etc.)
- 5,000 lumen projector with Cox Cable TV channels projects onto a 10 ft. x 12 ft. screen. A laptop may be attached to the projector for customized videos, presentations, etc.

ENCORE

- Customizable for any special occasion
- Connected to club XLIV by impressive, oversized sliding doors
- Space may be utilized only in conjunction with rental of club XLIV
- Separate entrance located at Girod Street
- 13 dimmable chandeliers

CATERING

- SMG's in-house caterer, Centerplate, retains the sole right to provide all beverage service

- Client may utilize Centerplate for food service or Client may opt to bring in an outside caterer of their choice
 - A per person catering buyout fee/minimum will apply
 - Caterers must be approved by SMG

RESTROOMS IN LOBBY AREA

- Men's restrooms: 12 facilities
- Women's restrooms: 12 facilities

ENTRANCES

- club XLIV entrance via Champions Square
- Encore entrance at Girod Street

PARKING / BUS DROP-OFF

- Convenient and accessible parking in close proximity offered at competitive rates
- Buses may access LaSalle Street and drop guests off directly at Champions Square (based on availability). If Champions Square is unavailable, buses may drop off at the Encore entrance located on Girod Street

EXCLUSIVES

- SMG is the exclusive operator of all existing audio and video equipment
- SMG Event Staff
- Centerplate is the exclusive beverage provider
- SMG facilities are Ticketmaster venues

CLUB XLIV & ENCORE



ENCORE

CLUB XLIV & ENCORE

- ⤿ BLACK SOFA & OTTOMAN
- ▢ IVORY SOFA & OTTOMAN
- ⌂ IVORY LOVE SEAT
- ⊕ (23) 42" ROUNDS OF 4
- ⊙ (9) 30" HIGHBOYS OF 3
- 10' X 12' WHITE FLAT SCREEN FOR PROJECTION
- ⊞ COLUMN WITH MIRRORS
- ★ CUSTOMIZABLE GOBO

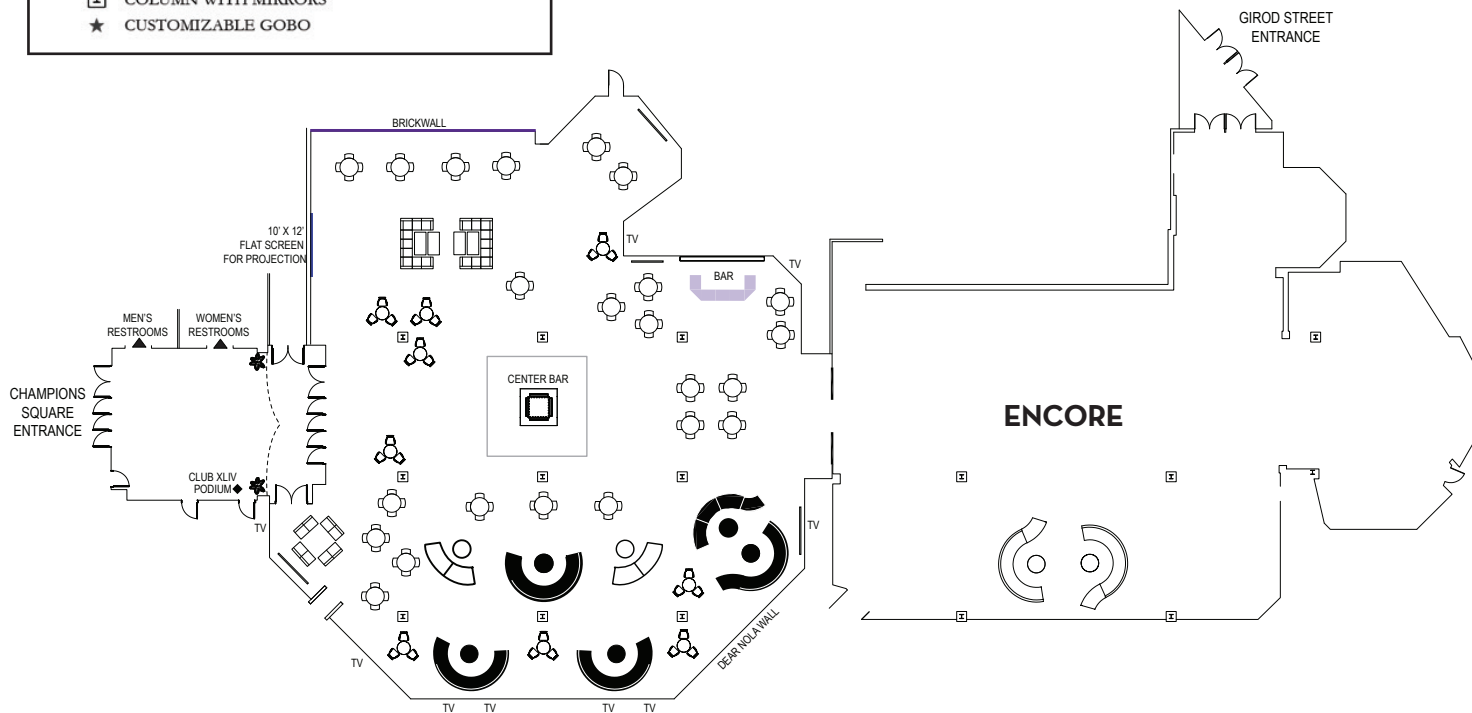

SITE MAP

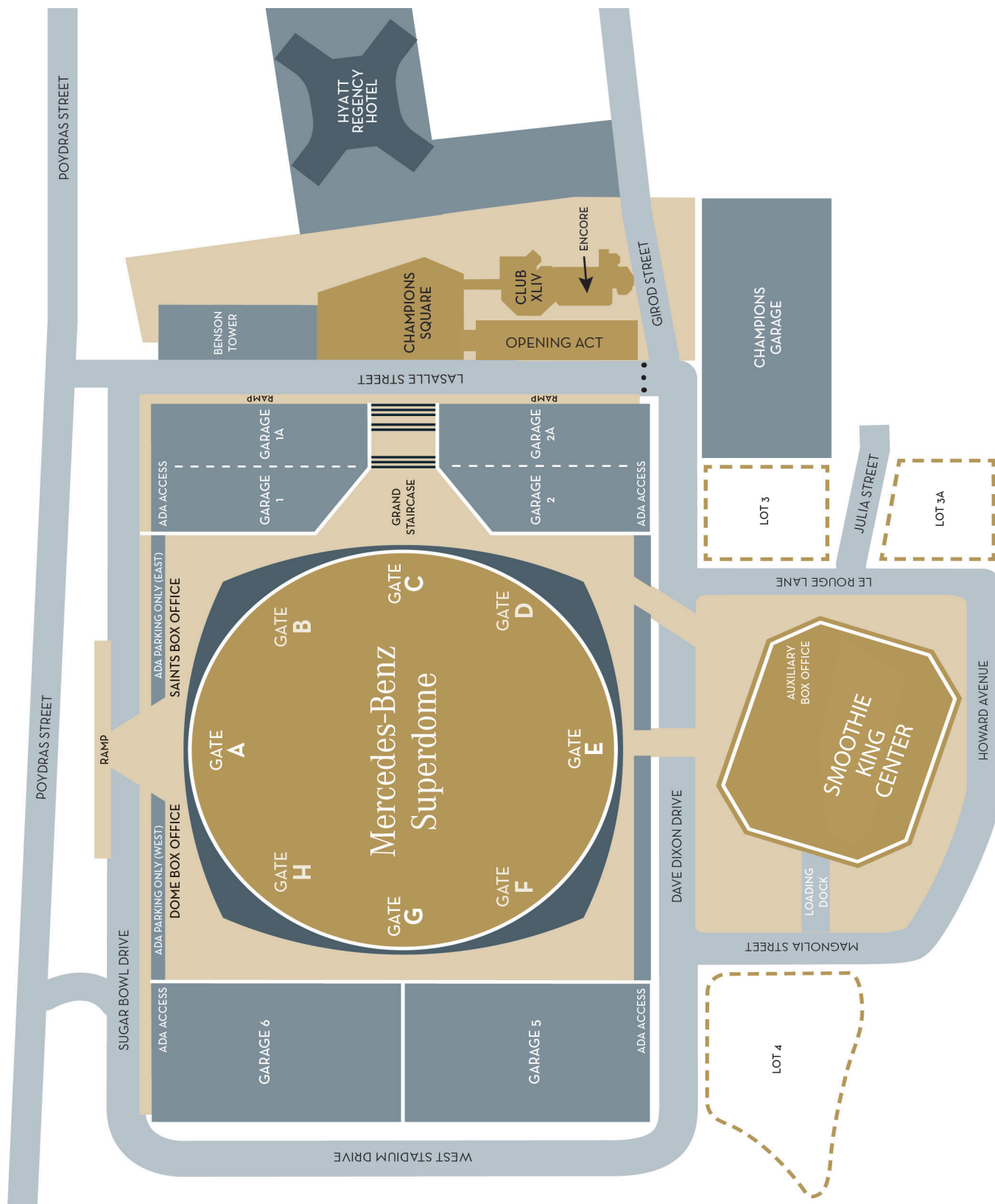

BACK OF HOUSE

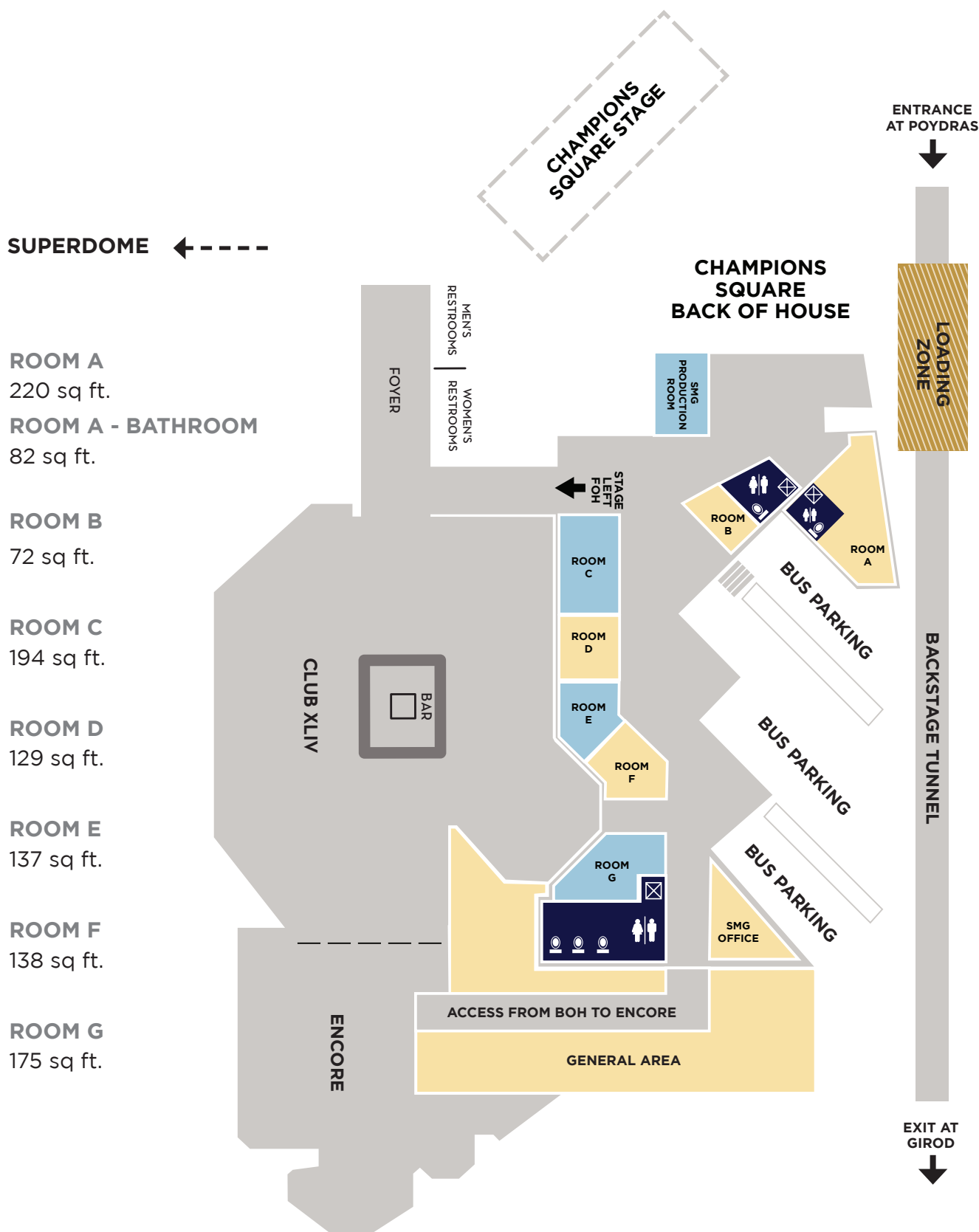

ROOF & RIGGING

ROOF

- Type: Tomcat BFT
- Main grid: 65' x 48'
48,000 lbs total weight
- Audio Bays: 19' x 17'
10,000 lbs on each side

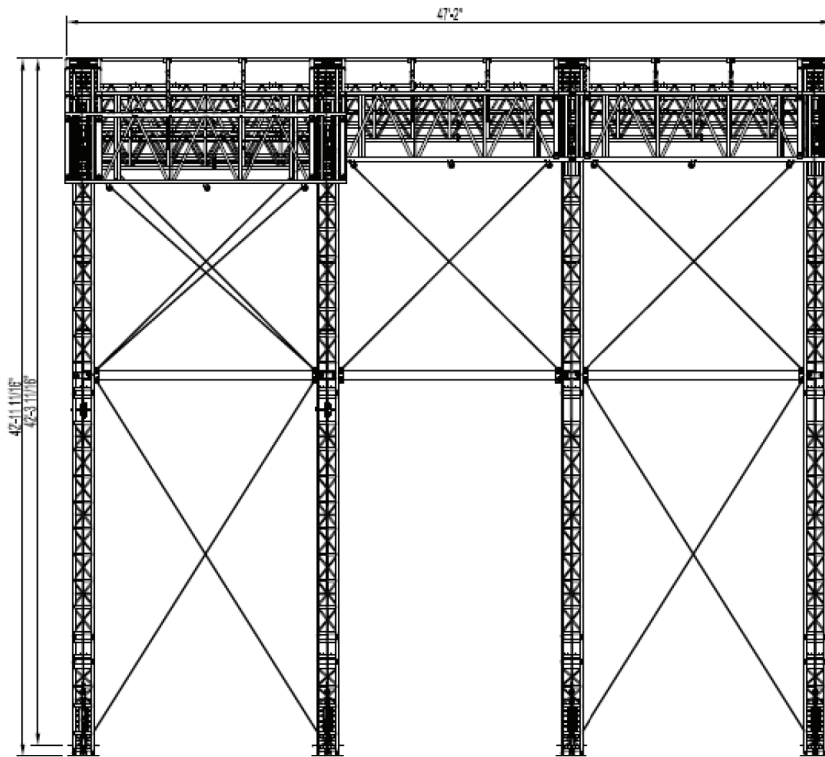
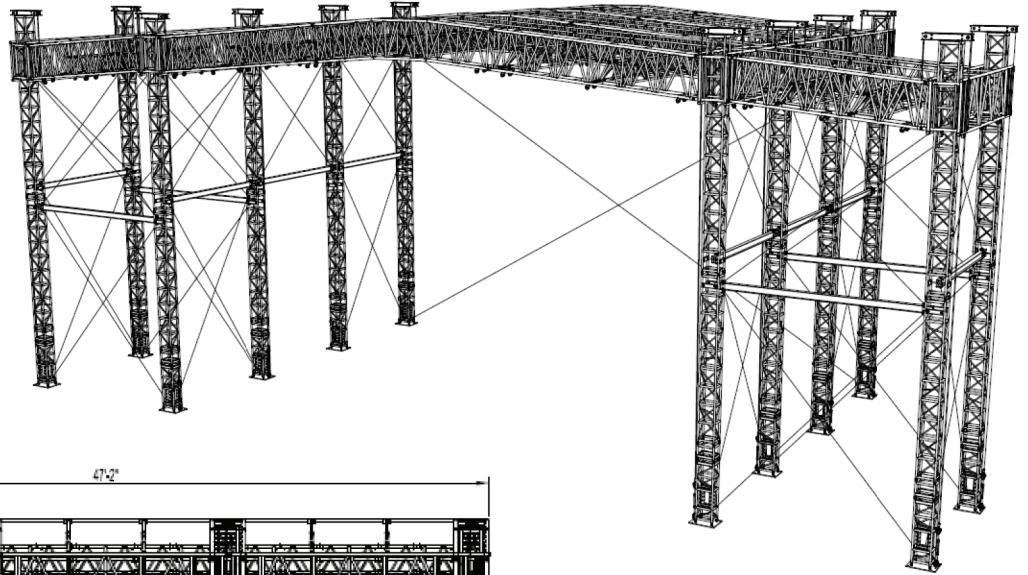

END